







# CogoCAD PRO

**NEW! GIS-Based CogoCAD PRO with Road Design and Contour/Volume: \$385.00 + S/H.**

CogoCAD PRO is a software program used in  **Surveying**,  **Landscaping**,  **Irrigation**,  **Forestry**,  **Archaeology**,  **Golf Course Mapping**,  **Graphic Design**, and other professions for managing data, designing survey plats, and generating maps. CogoCAD PRO works with Total Station survey data, GPS/GIS data, background images, Basemaps, and others. It lets you view and edit measurement data as well as coordinate data.

Primarily, CogoCAD PRO provides an interface to:

- ▶ **Download** data from survey data collectors
- ▶ Import data in ASCII, DXF, Shape File, and other formats
- ▶ **Adjust raw data**, coordinates and traverse data
- ▶ Add other **GIS data** to your map
- ▶ **Geo-reference** and display background image
- ▶ **Digitize** points, lines and polygons
- ▶ **Design roads** – View road cross-section by segment at any station
- ▶ Create **Deed Calls**

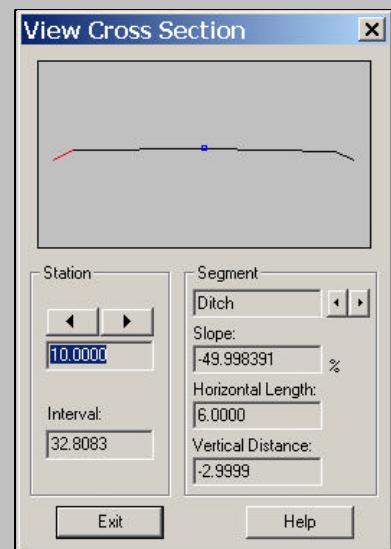
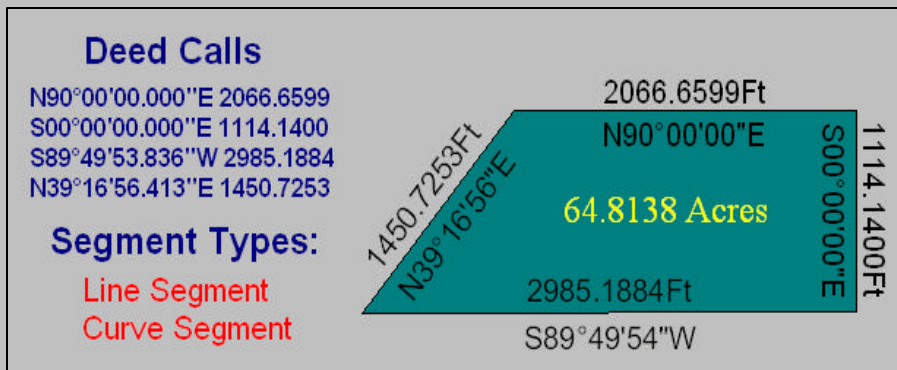

- ▶ Apply advanced **labeling** functions to segments, angles and areas
- ▶ Print out the finished map; print data to printer or to a file
- ▶ Perform extensive **Coordinate Geometry (COGO)** functions:
 

|   |   |  |
|---|---|--|
| <ul style="list-style-type: none"> <li>⊕ Inverse/<b>Traverse</b></li> <li>⊕ Intersection</li> <li>⊕ Corner Angle</li> <li>⊕ Direction Cut</li> <li>⊕ <b>Hinge Cut Area</b></li> <li>⊕ Radius Point</li> <li>⊕ <b>Multiple Points</b></li> </ul> | <ul style="list-style-type: none"> <li>⊕ 2-Pt Resection</li> <li>⊕ 3-Pt Resection</li> <li>⊕ <b>Spiral Curve</b></li> <li>⊕ <b>3 Point Curve</b></li> <li>⊕ Vertical Curve</li> <li>⊕ Horizontal Curve</li> <li>⊕ <b>Curve By Radius</b></li> </ul> | <ul style="list-style-type: none"> <li>⊕ Curve between Tangents</li> <li>⊕ <b>T/R/S Least Square Fit</b></li> <li>⊕ Translate/Rotate/Scale</li> <li>⊕ <b>Station Offset</b> <ul style="list-style-type: none"> <li>• Known Station and Offset</li> <li>• Known Coordinates</li> <li>• Known Measurement</li> <li>• Known Offset</li> </ul> </li> </ul> |
|---|---|--|

For a detailed list of functions available in **CogoCAD PRO**, please visit  
<http://www.cmtinc.com/software/COGO30.htm>



# Golf Course



# Surveying

- Irrig head
- Irrigation
- Trees
- Flag
- Tees
- Pond
- Tee off A
- Bunker
- Green
- Yardage
- Fairway

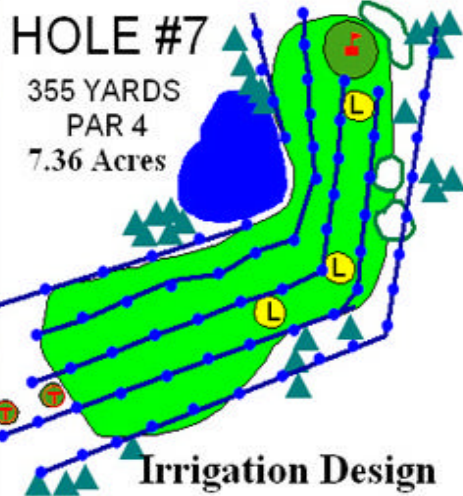

## 3-Point Curve

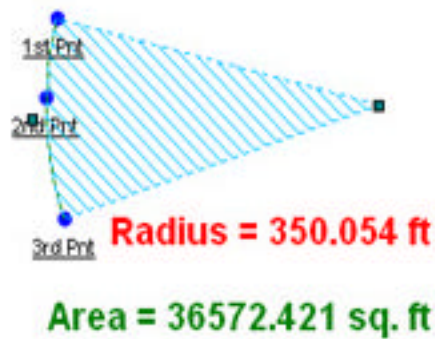

| 3 POINTS CURVE             |       |
|----------------------------|-------|
| Store                      | Reset |
| First Point:               |       |
| Topic1001                  |       |
| Second Point:              |       |
| Topic1002                  |       |
| Third Point:               |       |
| Topic1003                  |       |
| Radius: (Meters)           |       |
| 357.054                    |       |
| Segment: (M <sup>2</sup> ) |       |
| 1973.708                   |       |
| Sector (M <sup>2</sup> )   |       |
| 36572.421                  |       |

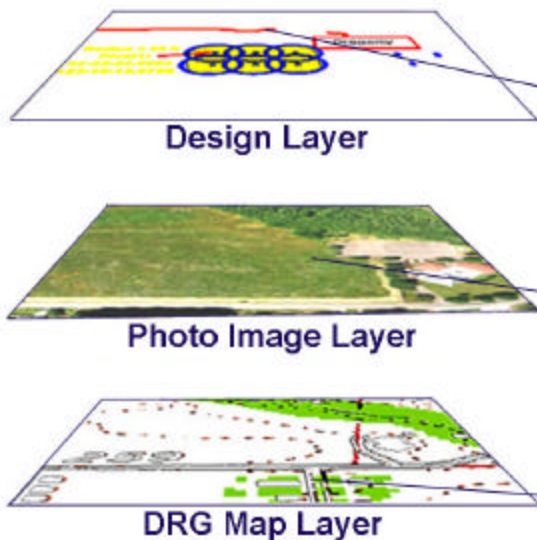

CMT SA III File (\*.PSA)

- Non-Spatial Data
- Pivot Point
- Irrigation Circle
- Seeding Bed
- Trail
- Building
- Property
- Treelarm.JPG
- 044123E3.TIF

**Landscape and Irrigation Design**

Property

Radius = 90 ft

Pivot1:  
44-33-24.0904  
123-18-13.9798

## CogoCAD PRO GIS Mapping Functions and Utilities:

- ▶ **Contour/Volume**
- ▶ Feature Topic
- ▶ **Heads-up Digitizing**
- ▶ GIS Layering
- ▶ Supports **BaseMaps**
- ▶ Marker Labeling
- ▶ Area Labeling
- ▶ Segment Labeling
- ▶ **Angle Labeling**
- ▶ **Earthworks**
- ▶ Assign Symbol by Topic
- ▶ Patterns and Symbols
- ▶ **Georeferenced Images**
- Supported formats include:
  - **Geotiff**
  - **GeoJPEG**
  - **MRSID® format**
  - JPEG2000
- ▶ **Solar/Star Observation**
- ▶ **Road Design**
- ▶ Zoom & Pan Tools
- ▶ **Plot Preview**
- ▶ Import & Export
- ▶ Geoid 2003
- ▶ Attach Photos & Video
- Email:**  
[support@cmtinc.com](mailto:support@cmtinc.com)

**CogoCAD PRO & CE Surveyor III Presentation**  
<http://www.cmtinc.com/nav/survpower.htm>